

**Address: 17 S MAIN ST**

**Owner: SOTO LORETTA ET MORTON MARLENE**

**Parcel: 41010038006100**

Parcel Profile

Address 17 | S | MAIN | ST

Street Status PAVED | SIDEWALK

School District UNION CITY AREA SCHOOL

Acreage 0.0505

Classification C

Land Use Code RESTAURANTS, STORES (RETAIL)

Legal Description 17 S MAIN ST 22X100

Square Feet 3510

Topo LEVEL

Utility ALL PUBLIC

Zoning Please contact your municipal zoning officer

Deed Book 0790

Deed Page 1296

2023 Tax Values

Land Value / Taxable 3,300 / 3,300.00

Building Value / Taxable 36,500 / 36,500.00

Total Value / Taxable 39,800 / 39,800.00

Clean & Green Inactive

Homestead Status Inactive

Farmstead Status Inactive

Lerta Amount 0

Lerta Expiration Year 0

Commercial Data

**Card 1** MIXED RES/COMM

Business Living Area - 3510

Year Built - 1884

Improvement Name - VACANT STORE

Value - 36480

Sales History

Sale Date	From	To	Type	Price	Book / Page	Other Info
7/9/2001		SOTO LORETTA ET MORTON MARLENE		0	0790 / 1296	
8/16/1995		PFISTER DAVID LEO ETALS	LAND & BUILDING	25000	398 / 1776	

Parcel Sketches

Commercial Card 1

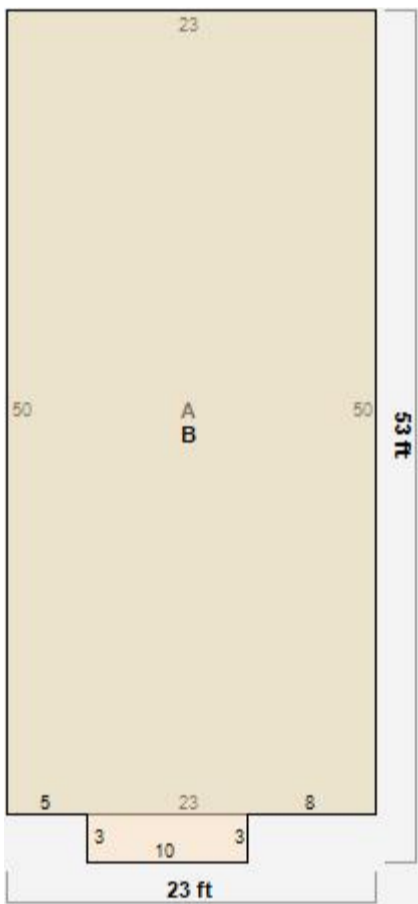

A MAIN

1150 square feet

B MAIN

1180 square feet

# Parcel Images



# Annual Taxes

**Attention City of Erie Residents**

Please be advised that due to the recent change in the billing cycle for the City of Erie school taxes, the total for Year 2012 (school tax column) will now include the total amounts for both the 2011-12 AND the 2012-13 tax years.

Year	County	City/Township	School	Library	Total
2023	237.21	350.64	476.41	0	1064.26
2022	237.21	350.64	470.83	0	1058.68
2021	237.21	350.64	458.50	0	1046.35
2020	227.26	320.79	470.04	0	1018.09
2019	227.26	320.79	454.12	0	1002.17
2018	215.32	320.79	446.56	0	982.67
2017	215.32	320.79	452.13	0	988.24
2016	205.37	280.99	436.61	0	922.97
2015	196.21	280.99	418.30	0	895.50
2014	196.21	241.19	407.15	0	844.55
2013	196.21	241.19	422.68	0	860.08
2012	254.71	294.70	527.09	0	1076.50
2011	254.71	231.55	514.88	0	1001.14
2010	254.71	231.55	505.62	0	991.88
2009	229.45	189.45	500.57	0	919.47
2008	218.92	189.45	500.57	0	908.94
2007	208.40	189.45	500.15	0	898.00
2006	208.40	147.35	489.04	0	844.79
2005	197.03	147.35	520.78	0	865.16
2004	197.03	147.35	520.78	0	865.16
2003	193.66	147.35	445.00	0	786.01

# Delinquent Taxes

Tax Year 2007	Tax	Penalty	Interest	Total	Paid/Exon	Balance
COUNTY	208.40	20.84	1.72	230.96	230.96	0.00
TWP/BORO/CITY	189.45	18.95	1.56	209.96	209.96	0.00
LIBRARY	0.00	0.00	0.00	0.00	0.00	0.00
SCHOOL	500.15	50.02	4.13	554.30	554.30	0.00
SCHOOL LIBRARY	0.00	0.00	0.00	0.00	0.00	0.00
<i>FEES</i>				65.00	65.00	0.00
					<b>2007 Total Due:</b>	<b>\$0.00</b>
Tax Year 2019	Tax	Penalty	Interest	Total	Paid/Exon	Balance
COUNTY	0.00	0.00	0.00	0.00	0.00	0.00
TWP/BORO/CITY	0.00	0.00	0.00	0.00	0.00	0.00
LIBRARY	0.00	0.00	0.00	0.00	0.00	0.00
SCHOOL	454.12	45.41	3.75	503.28	503.28	0.00
SCHOOL LIBRARY	0.00	0.00	0.00	0.00	0.00	0.00
<i>FEES</i>				38.00	38.00	0.00
					<b>2019 Total Due:</b>	<b>\$0.00</b>
Tax Year 2020	Tax	Penalty	Interest	Total	Paid/Exon	Balance
COUNTY	227.26	22.73	61.87	311.86	0.00	311.86
TWP/BORO/CITY	320.79	32.08	87.34	440.21	0.00	440.21
LIBRARY	0.00	0.00	0.00	0.00	0.00	0.00
SCHOOL	470.04	47.00	127.97	645.01	0.00	645.01
SCHOOL LIBRARY	0.00	0.00	0.00	0.00	0.00	0.00
<i>FEES</i>				0.00	0.00	445.00
					<b>2020 Total Due:</b>	<b>\$1,842.08</b>
Tax Year 2021	Tax	Penalty	Interest	Total	Paid/Exon	Balance
COUNTY	237.21	23.72	41.10	302.03	0.00	302.03

TWP/BORO/CITY	350.64	35.06	60.75	446.45	0.00	446.45
LIBRARY	0.00	0.00	0.00	0.00	0.00	0.00
SCHOOL	458.50	45.85	79.44	583.79	0.00	583.79
SCHOOL LIBRARY	0.00	0.00	0.00	0.00	0.00	0.00
<i>FEES</i>				0.00	0.00	138.00
<b>2021 Total Due:</b>						<b>\$1,470.27</b>
<b>Tax Year 2022</b>	<b>Tax</b>	<b>Penalty</b>	<b>Interest</b>	<b>Total</b>	<b>Paid/Exon</b>	<b>Balance</b>
COUNTY	237.21	23.72	17.61	278.54	0.00	278.54
TWP/BORO/CITY	350.64	35.06	26.03	411.73	0.00	411.73
LIBRARY	0.00	0.00	0.00	0.00	0.00	0.00
SCHOOL	470.83	47.08	34.96	552.87	0.00	552.87
SCHOOL LIBRARY	0.00	0.00	0.00	0.00	0.00	0.00
<i>FEES</i>				0.00	0.00	78.00
<b>2022 Total Due:</b>						<b>\$1,321.14</b>
<b>Grand Total Due:</b>						<b>\$4,633.49</b>

Delinquent Tax Payments for this parcel are restricted.  
Please contact the Erie County Tax Bureau for more information at 814-451-6206.

## Owner Info

**PARCEL ID:** 41-010-038.0-061.00  
**OWNER 1:** SOTO LORETTA ET MORTON MARLENE  
**OWNER 2:**  
**ADDRESS 1:** 14 JOHN ST  
**ADDRESS 2:**  
**ADDRESS 3:**  
**CITY:** UNION CITY  
**STATE:** PA  
**ZIP 1:** 16438  
**ZIP 2:** 1436  
**LEGAL 1:** 17 S MAIN ST 22X100  
**LEGAL 2:**  
**LEGAL 3:**